



208 38 Windmill Street, Birmingham

Birmingham

Guide Price **£305,000**



208 38 Windmill Street

, Birmingham

Spacious 2-bed city-centre apartment with open-plan living area and ensuite. Amazing transport links and close to shops, dining and entertainment. No maintenance or fuss. Ideal flat share - Call now!

Tenure: Leasehold

- GREAT LOCATION
- SPACIOUS APARTMENT
- 2 BEDROOMS ONE WITH ENSUITE
- GREAT TRANSPORT LINKS
- CITY CENTRE LOCATION
- CONCIERGE





Windmill Street, Birmingham, B1

Approximate Area = 698 sq ft / 64.8 sq m

For identification only - Not to scale

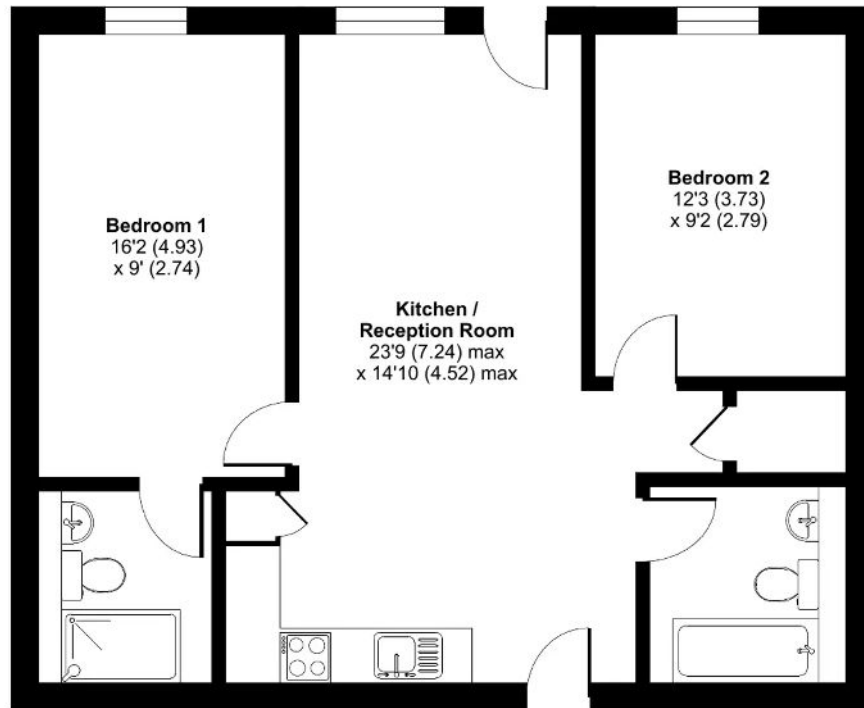

SECOND FLOOR



**Certified
Property
Measurer**

Floor plan produced in accordance with RICS Property Measurement Standards incorporating International Property Measurement Standards (IPMS2 Residential). © nchecon 2023. Produced for Residential Properties Investments LTD la Complete RPI. REF: 1004944



Empire

27 Frederick Street, Birmingham - B1 3HH

0121 514 8850 • info@empirelpm.com • www.empirelpm.com/

