



City Green, Coventry Road, Birmingham
Birmingham

£185,000



City Green, Coventry Road

, Birmingham

A new stunning collection of only 84 apartments, City Green is ideally located only a few minutes away from Birmingham City Centre, The Airport, Exhibition Centre and also located directly across from Sheldon Country Park, Birmingham's largest green space.

Tenure: Leasehold

- Collection Of Only 84 apartments - Completing Q3 2023
- Car Parking Space Available & Electric Charging Points
- Variety Of One, Two and Three Bedroom Apartments Available
- Ground Floor Apartments Available With External Garden Space
- Show Apartment Now Available





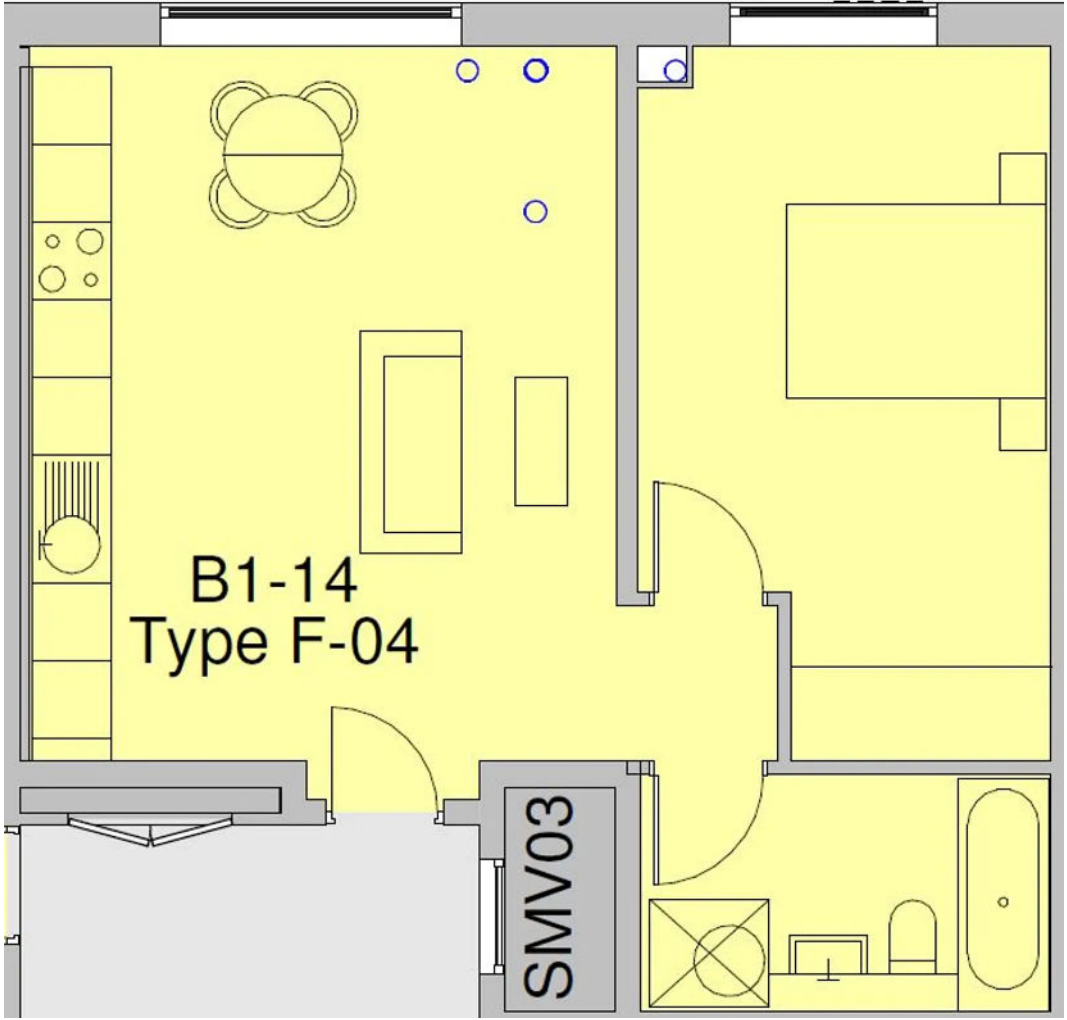



Empire

27 Frederick Street, Birmingham - B1 3HH

0121 514 8850 • info@empirelpm.com • www.empirelpm.com/

